

# RAMAIAH MEDICAL COLLEGE INFRASTRUCTURE



MSR Nagar, MSRIT Post, Bangalore – 560 054

Tel: 080 23605190 / 1743/ 5408; Fax: 080 23606213

E mail: [msrmedical@msrmc.ac.in](mailto:msrmedical@msrmc.ac.in)

Web: [www.msrmc.ac.in](http://www.msrmc.ac.in); [www.ramaiah-india.org](http://www.ramaiah-india.org)



 **RAMAIAH**  
Medical College Hospital

 RAMAIAH  
Medical College Hospital



# CONTENTS

1) Introduction .....	1
2) Central museum .....	2
3) Medical College Hospital .....	2
4) Central Research Laboratory .....	3
5) Department of Physiotherapy .....	3
6) Advanced Learning Centre .....	4
7) Ramaiah Memorial Hospital .....	4
8) Mortuary .....	4
9) Technology-enabled learning spaces .....	4
10) Sports and Cultural Activity Facilities .....	5
11) Indoor Games .....	8
12) Infrastructure available for cultural activities .....	9
13) General facilities .....	10
14) Ramaiah Medical College Hospital .....	12

# Introduction



M.S Ramaiah Medical College & Hospitals (NABH accredited) is a spacious lush green campus spread across of 61.395 Acres located in Bengaluru. The infrastructure created is over and above the requirements of the Statutory Bodies (Medical Council of India and Indian Association of Physiotherapists) and are spread over 8 building blocks on its campus.

There are 21 Lecture Halls, 27 Laboratories, 58 Seminar halls and 4 Auditoriums on campus equipped with ICT enabled and computing facilities.





- The College is a multistorey building with a built-up area of 32794.77 square meters.

#### Amenities

- 7 IT enabled lecture halls
- Board room
- Council Hall
- Auditorium

### Medical College Hospital



The Medical College Hospital is a five storied building with an area of 41,527.194 sq. meters housing OPD, IPD, Ward, ICU, OTs & other patient care areas.

#### Amenities

- Board room
- Auditoriums
- Refreshment cafes

### Central museum



The integrated central museum was started in 2015 and is located on the first floor of the college with departments of Anatomy, Pathology, Microbiology, Pharmacology and Forensic Medicine accommodated in 929.030 sq. met space. A table-top computer with 3D visualization software, screen with LCD projection and 4 electronic screens have been installed. The bay area is used for display during various programs.

#### Specimens

- Anatomy - 682
- Pathology - 1315
- Pharmacology - 350
- Microbiology - 337
- Forensic Medicine - 512

## Central Research Laboratory



Central Research Laboratory is in the first floor of medical college hospital with an area of 650.32 square metres provides a platform to conduct research required to undertake cutting-edge research in biomedical sciences strengthening training beyond academic mandates. A total of 55 research projects have been completed.

- Cytogenetics
- Fluorescence in situ hybridisation (FISH)
- PCR
- Immunohistochemistry
- Immunofluorescence
- Basic biochemical analysis facility
- Analytical facility with spectrophotometry and High Performance Liquid Chromatography
- Phytochemicals/ chemical extraction facility.
- Multifunction plate reader (UV-Visible, fluorescence, ELISA, Chemiluminescence)  
Electrophoresis – serum protein and hemoglobin
- Cell and tissue culture facility
- Deep freezer facility for DNA storage

## Department of Physiotherapy



The Department of Physiotherapy is on the 3rd floor of the Medical College Hospital with an area of 1,130.53 sq. metres. It is well equipped for teaching learning activities.

A state of art Rehabilitation centre. The center has:

- Isokinetic testing unit.
- Gaitrite.
- CPET Analysis.
- Advanced balance training unit.

## Advanced Learning Centre



Advanced Learning Centre: spread over 1858.06 sq. meters area houses the skills lab, simulators, Cadaveric Lab. It provides basic and advanced skills training for undergraduate and postgraduate students and practicing doctors.

## Ramaiah Memorial Hospital



The Ramaiah Memorial Hospital is a 10 storied building with an area of 54,986.52 sq. meters.

### Amenities

- Board room
- Auditoriums
- Terrace garden
- Refreshment cafes

**Mortuary:** The mortuary is a 2-storey building, with a total area of 465 sq. meters and is equipped with 2 cold storage cabinets capable of storing 10 dead bodies. The mortuary is well ventilated with requisite inquest rooms for police and a mourner's room. A student gallery is provided with a capacity of 60 students to witness autopsy.

## Technology-enabled learning spaces



**Technology-enabled learning spaces:** The campus is Wi-Fi enabled with more than 1 GB internet with 1160 computers available. The Institution uses MS Teams, GEMS and Moodle platforms for teaching learning activities. The classrooms and seminar halls are provided with LCD's and two class rooms with smart boards. A high-tech video conferencing and recording at the Advanced Learning Centre enables web-based education and training. 4 Auditoriums with 200 – 2000 capacity with high-end facilities are available.

# Sports and Cultural Activity Facilities

The Institution has adequate infrastructure for sports, games and cultural activities. Special attention is given for the health and fitness of the students. A dedicated annual budget for Cultural, Sports, Arts and Literary activities is allocated every year. Expenses for the participation, registration, travel, accommodation, jerseys for various college sports teams, costumes for cultural activities and sports equipment are provided by the Institution every year for the students. The students are encouraged to participate in inter collegiate, State level and National Level activities.

**Sports:** RMC has made provision for standard indoor/outdoor sports facilities, multi-gym and fitness centre, with trained instructors, training, and motivating participation by the students. The Institution has a Sports Committee overseen by a faculty. The students select a sports secretary every year. The Committee oversees both indoor and outdoor sports activities for students and staff.

**Indoor:** The Institution has facilities for indoor games like table tennis, basketball, carom board etc. within the campus.

**Outdoor:** Playgrounds are available in the GEF campus for outdoor games like Volleyball, Basketball & Tennis.

Teams are selected and sent to participate in inter-institutional and national-level activities. The Institution has also a ground owned by the Trust within 1 km from the campus, which is used by the students for playing Cricket, Football, Hockey etc.

**Gymnasium:** RMC has provided well-equipped gymnasiums one each for boys and girls.

**Yoga centre:** The Institution has a holistic health centre within the campus and regularly conducts yoga classes for students and interested staff. Yoga Centre is well equipped with charts and facilities for proper conduct of yoga sessions. Under the able guidance of a yoga teacher sessions for patients, faculty members and students are conducted regularly.

**Cultural activities:** The Institution has an active cultural committee headed by a faculty and student council members. The committee meets regularly and plans the calendar of events for cultural activities both within the campus and to participate in the events organised by other colleges. The annual student cultural events are organised with great enthusiasm, pageantry and discipline. The main auditorium serves as the venue for the events. This three-day extravaganza serves as a platform for both students and faculty to display their talents. Felicitations of prize winners in sports and cultural competitions are done in annual social functions.

**The Literary committee:** which has the scope to showcase the talents of students and staff like debates, literary talents, poetry, photography etc.

**The Arts club:** is instituted to garner the talent of various forms of arts and crafts by the students. An Easel for portrait painting has been made available to facilitate use by the students. The art committee creates theme-based décor items, props etc. during the intra- collegiate and inter-collegiate cultural and sports festivals organized by the Institution.

**Recreational facilities** – Four auditoriums are available and are used for cultural activities and other student council activities. Common rooms for girls and boys are in place in the Institution.



# The institution has adequate infrastructure for sports, games, yoga and cultural activities.

## SPORTS

- The institution has facilities for both indoor games and outdoor games.
- The institution has a play ground owned by the GEF Trust with in a distance of 1 km from the campus which is used by the students for playing sports.
- The following sports are played at our institution:

### Outdoor Games

1. Basketball Men and Women
2. Cricket
3. Football
4. Tennis Men and Women
5. Volleyball Men and Women
6. Throw ball Men and Women
7. Athletics Men and Women

### Indoor Games

1. Table Tennis Men and Women
2. Carom board Men and Women
3. Basketball Men and Women
4. Badminton Men and Women
5. Chess Men and Women

- The institution has a sports committee chaired by a faculty of the rank of professor who was a national level basketball player.
- The students select a sports secretary every year amongst themselves.
- The committee oversees both indoor and outdoor sports activities for the students and staff.
- The institution has appointed a Sports Officer, who is a qualified physical education trainer on a full time basis.
- The Sports Officer regularly draws up a structured training programme for all participants who are participating in various inter-college, university and inter-university competitions/sports.
- He also coordinates and liaises with various colleges/institutions for competitions.

## BASKETBALL COURT



One Basketball Court for Girls and Boys.

Overall dimension is 28 meters ( length) by 15 meters (width) with 5 meters of free area with a capacity to seat 500 individuals.

## MULTIPURPOSE GROUND

Multipurpose ground with pavilion For Cricket, Football, Volleyball, Throw Ball, Field Hockey and Athletics

Land area: 1,46,470 Square foot

Location: Survey No. 44, Chikkamaranahalli, New BEL Road, Mathikere, Bengaluru-560054



All sides of the sports ground area is surrounded by compound wall of 7feet height.

Pavilion stand has seating arrangement for 1000 students.

1500sq ft soft built up area accommodating toilets ad dressing rooms for students.

Two fully prepared cricket practice nets.

200meters running tracks.

Prepared Football ground.

## TENNIS COURT



Prepared ground for volley ball, throw ball & hand ball.

Overall dimension of the court is 23.77 mtrs long and 10.97 mtrs width 21 feet free playing area.

# INDOOR GAMES

## CARROM



10 carrom boards for students and faculty to use in their free time

## BADMINTON COURT



Overall dimension of the court is 20 feet (width) by 44 feet (length) with 2.5 meters of free zone area, and about 50 member seating capacity.

## TABLE TENNIS



Six new table tennis tables with nets for students and faculty in the sports room

## GYMNASIUM



Gym Location: Nilgiri Hostel Block

# INFRASTRUCTURE AVAILABLE FOR CULTURAL ACTIVITIES

## Auditorium 3<sup>rd</sup> Floor Ramaiah Medical College



A spacious air-conditioned auditorium with a seating capacity of 800 equipped with good architectural & auditorium acoustics, Projection facilities, Mikes. The auditorium facility is used to host inter and intra-collegiate fests, Conferences , Graduation day ceremony and many other cultural and literary events.

## Open Air Theatre

An Open air theatre - Murali Van adjacent to parking area serves as a platform for cultural activities hosted by the GEF institutions.



## Dwarka Auditorium



Dwarka hall - 1000 seating capacity adjacent to MSRUAS is a facility made available to all GEF institutions to host combined as well as individual events. A combined Kannada Rajyotsava fest was organized on the 29th of November 2019.

Practice area on the 3<sup>rd</sup> floor adjacent to RMC auditorium & -1 basement of RMC is available for students to practice Dance and other cultural activities. This area is also made available for Yoga sessions conducted by faculty for students.





# GENERAL FACILITIES

Ramaiah Medical College is built amidst a green environment with wide open spaces and access roads equipped with all the amenities that are staff and student-friendly.

## HOSTELS

RMC has two hostels for boys (391 rooms & 539 Capacity) and one for girls (538 rooms & 639 Capacity) with single and twin sharing rooms. The hostels are equipped with TV rooms, Wi-Fi connectivity, recreation room, gym, visitors' room, guest rooms, CCTV surveillance cameras, dining room facilities and cafeteria, reading room, security service, and solar heaters. Wardens assigned to various blocks look after the hostels. The Institution has hostel facilities with eleven rooms at Kaiwara for students posted in Rural Health training centre and four rooms at Ramaiah Leena Hospital.

## MEDICAL FACILITIES

Students and staff have access to comprehensive health care and medical facilities. The College ensures prophylactic Hepatitis B vaccination for students.

## TOILETS

The campus has adequate clean toilets in all the buildings and hostels that include access for the specially-abled and grab bars for senior citizens in the hospital.

## CANTEEN

There is a Food Street within the campus catering to the needs of staff, students, and patient attendants. The Department of Community Medicine monitors hygienic practices here.

## POST OFFICE

The campus Post Office caters to the needs of students, faculty and staff. The pin code of this post office is 560054.

## BANK

All banking services including ATM facilities are provided by the campus branch of Bank of Baroda & Axis Bank.

## Roads and signages

The campus has well laid-out asphalted and tree-lined roads that are illuminated at night and paved with pedestrian-friendly foot paths.

## RO PLANT

Four RO plants are installed in the campus.

## ALUMNI ASSOCIATION

There is a well-equipped alumni office used by the office bearers for all alumni activities.

## ALTERNATE SOURCES OF ENERGY:

- GEF has an agreement with M/s. Atria Energy Services Private Limited, for the supply of Solar power installed from their partners namely M/s. Atria Solar Power (Chamaraj Nagar)
- A 20 KW Solar Power plant is installed in the campus through M/s. TATA Solar Power Company.
- A model hybrid solar and wind power generator is installed which lights up adjacent park lights.

**Solar water heating systems** amounting to 45KLD is installed in the campus.

## Water Purification Plant

There is an effective water purification plant with a capacity of 250 KLD for the RMH and 450 KLD for the RMC, RMCH and Hostels.

**Waste Management** on the campus is carried out completely in accordance with the regulatory requirements. RMC is a training center for waste disposal methods for 5 states. (UNIDO-Vienna Project)

## Rain water harvesting and utilization:

The campus is designed with ground water recharging system of all the eleven borewells which serve the medical college and hospital. There are 3 underground sumps to capture the rainwater with a total capacity of 5 lakh liters.

The Campus is equipped with a Book store, Laundry facility and an optical store for ease of access of students. There are grooming salons made available on campus for both Girls and Boys.

# Ramaiah Medical College Hospital

Ramaiah Medical College Hospital is a 1365-bedded modern tertiary care hospital housed in two buildings spread over 8966.88 Sq. meters area with state-of-the-art facilities for broad specialty, super-specialty and diagnostic care catering to the population of North Bangalore and adjoining districts. Accredited by NABH with pivotal infrastructure and equipment as stipulated by the MCI the hospitals support innovative teaching programs with ICT-enabled facilities. The Operation theatres are equipped with facilities that enable students view live surgical procedures.

There are 10 ICU's, 21 Operation Theatres and Broad and Super Specialty OPDs. The beds in the hospital have been organized as per MCI and departmental requirements for teaching and learning purpose and good patient care. Each ward has beds, nursing station and other supportive services required along with Clinical demonstration room and seminar hall for teaching and learning. Equipment are procured for the departments based on the scope of services of the hospital and also as per the statutory requirements. All OPDs have Seminar hall and Clinical demonstration rooms and individual departments also have seminar hall for teaching and learning activities.

The following are some of the facilities available at the hospital

- NABH and NABL Accreditation
- Blood Bank with facility for Blood components and whole blood.
- Atomic Energy Regulatory Board approved radiation equipment and protocols.
- State-of-the-art Radiation Therapy facility with PET based planning facility conforming to international standards.
- Movement disorder clinic with deep brain stimulation.
- Da Vinci Surgical Robot to aid in precision minimally invasive surgery.
- Facilities for Plastic and microsurgery for complex deformities and trauma
- Renal, Heart, Liver, Corneal and bone marrow transplantation done on a regular basis.
- Nodal centre for Disaster management, ACLS and ATLS training centre
- Facilities for advanced endo-vascular procedures and a state-of-the-art foot clinic.
- Centre for joint replacement surgery and spinal surgery.
- Centre for Rehabilitation- Gait Analysis Unit, Iso-kinetic Testing and Hydrotherapy.
- Transgender Clinic
- Artificial Limb Centre
- Collaborative Child Abuse Responsive Unit
- LASER and Aesthetic centre
- Geriatric Clinic



## **NABL accredited Laboratories**

provide Comprehensive Laboratory services. The Laboratory is headed by the Chief of Laboratory who is Professor at the Ramaiah Medical College. The Chief of Laboratory defines; implements and monitors standards of performance and quality of the Laboratory and also implements the Quality Management System as per NABL standards (ISO 15189) Goals are set for the development of the laboratory and budgetary and resource allocation is made based on priority for the various sections in the Laboratory. Reviews of financial performance of the service are done from time to time, to provide safe laboratory environment in compliance with good laboratory practices and applicable regulations.

**Telemedicine services** are available with the Department of Radiology. Geriatric Clinic connects using these services with patients in Kaiwara. The Memorial Hospital is also equipped with online consultation services in various specialties powered by Carenation and Mymedic apps.

The Hospital has a robust electronic system installed that enables Patient Registration, Health records, IPAC for radiology investigations, Laboratory Investigations. Out- Patient services are available on the Electronic Health Records.



The College website is linked with Library details. It provides information on services available in the library. The Online Public Access Catalog (OPAC) facility enables the users to search online, locate books and other materials available in the library.

URL for the library OPAC <http://49.206.31.201:8086/msrhc/>

Login user ID-GUEST & PW-guest

Total Collection	Books - 021838 Book Bank - 0733
Total Available Collection	019898
Total titles	017086
Total volumes	019192
Total text- books	014469
Total references	004723
Total journals (P & E)	Print-155, E-Journals -675
Rare book	65
Manuscripts (T&D)	NO
Special reports	20 (FROM 2014-2018)
Thesis	04
Dissertations	1495 Hard copy + 66 CD's =1561

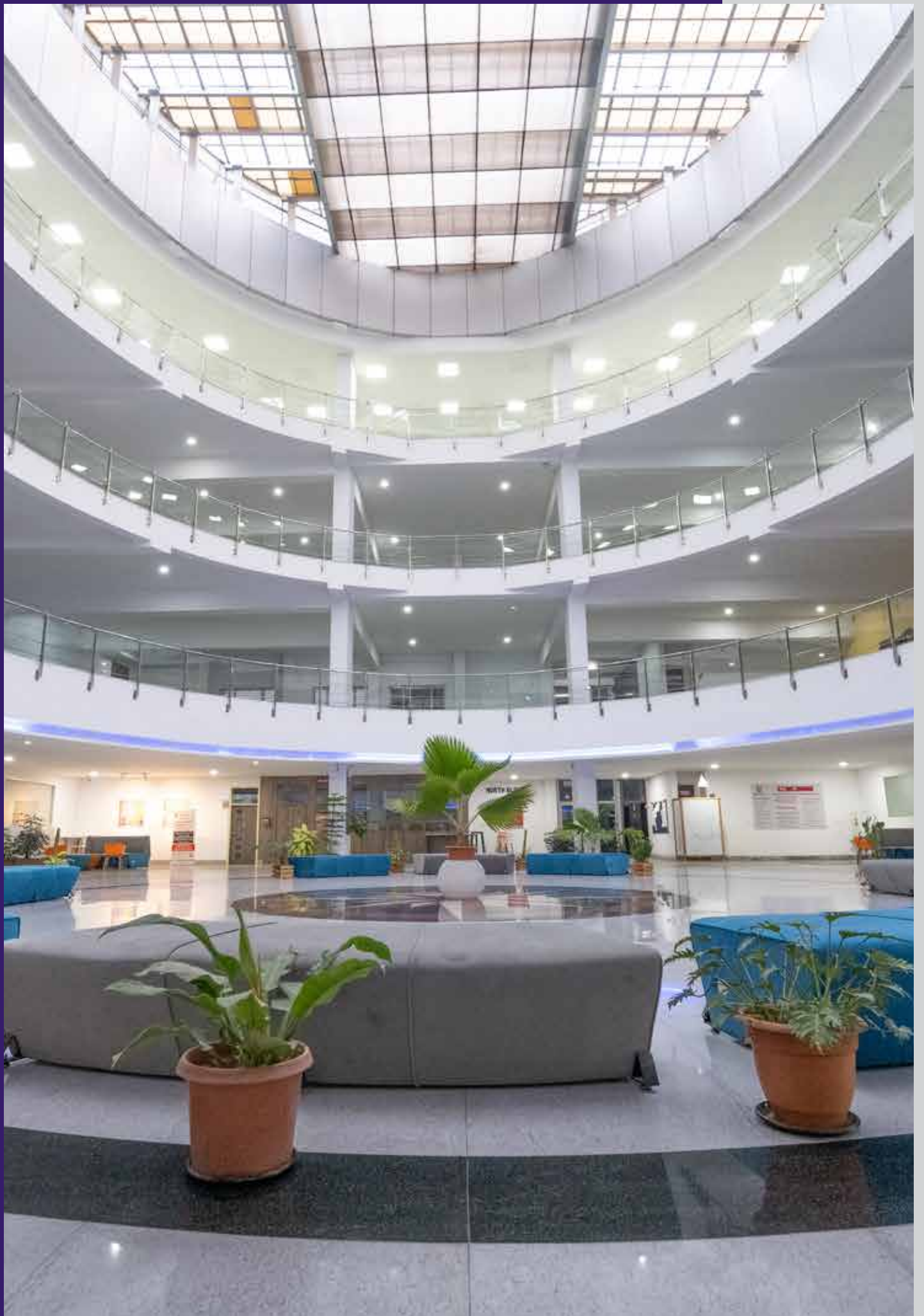





**RAMAIAH**  
Medical College